

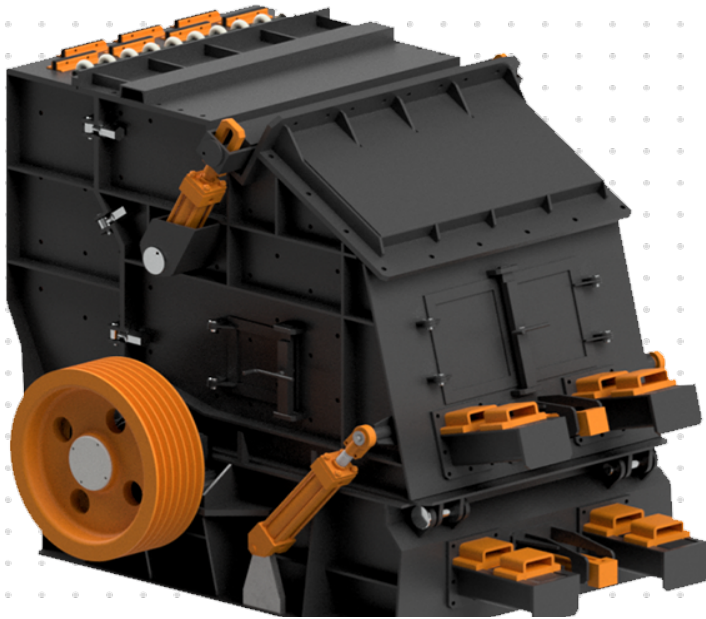

ATHOX

# HORIZONTAL CRUSHER IMPACTOR



AGGREGATE

## OVERVIEW

Athox Horizontal Crusher Impactors are the most versatile machines used in aggregate operations due to high quality, cubic product and high capacities in one piece of equipment. In comparison to jaw and cone crushers, the crushing forces generated during the impact process reach rock fractures more effectively, as well as break any edges leaving the material more cubic.

## BENEFITS

- Cost Benefit. Open rotor design with high inertia provides lower cost of ownership. Impact breaking is the basic principle. Lower maintenance cost.
- Can produce more cubic aggregates.
- Lower reduction ratio which can often eliminate the need for a secondary or tertiary crusher.
- Reduction ratios of 20:1 or more are quite realistic for an impact crusher.
- An impact crusher with two rotors and shields, primary, secondary and tertiary can achieve a 50: 1 ratio.
- Easy handle to adjust the size of output material.
- Feeder opening with chain curtain and rubber layer for material retention into the chamber.
- Main shaft with oversized dynamic load capacity, self-aligning roller bearings design with grease lubrication.
- With the tertiary crushing chamber, it is possible to achieve excellent control of the maximum particle size reached in the curve.
- Safety – Easy to handle: Rotor Locking Tool, Hydraulic Curtain Adjustment to easily adjust the crusher's closed side setting (CSS).

# HORIZONTAL CRUSHER IMPACTOR

## QUICK ADJUSTMENTS & MAINTENANCE

Impactor is driven by a belt pulley transmission and electric motor, with easy accesses to adjust the size of output material, Crushing chamber adjustment is made easy with quick service access doors, hydraulic unit for driving the adjustment cylinders, easy access for liner, blow bars and side liner plate replacement. Quick opening of the chamber systems for easy and fast way to remove uncrushable materials.

## MANUFACTURE

Structure manufactured in carbon steel, blow bar material high abrasive resistance alloy steel or high chrome. Curtains with adjustment by lead screw and shim mechanism. Primary, secondary and tertiary curtains are manufactured using ASTM A36 steel structure with a high abrasive and impact resistant steel liner. Curtain positioning adjustment is lead screw with shim mechanism for maximum rigidity under high loads and side liners plates are AR350 steel with a high resistance to impact and abrasion. Also includes rotor and lid lock for safe service of the equipment.

## FEED TRAY

Impactor features two curtains specially designed for cubic particles products. The curtains set up is adjustable shim mechanism with overload protection to relieve pressure under non crushable materials. Material flow is optimized and wearing is reduced due the bypass feeder design.

Crushing process is enhanced due the high technology on curtains and blow bars designs.

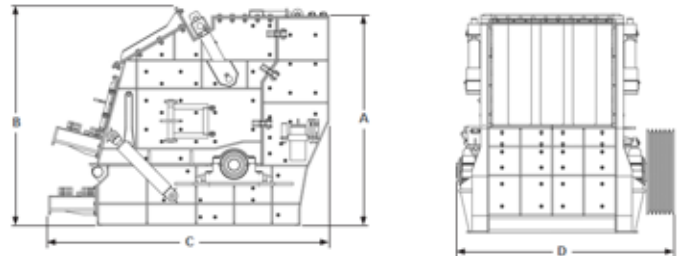

## TABLE OF PRODUCT ANALYSIS

HSI CRUSHER DIMENSIONS								
MODEL	A		B		C		D	
	IMPERIAL	METRIC	IMPERIAL	METRIC	IMPERIAL	METRIC	IMPERIAL	METRIC
HSI 500	38"	960mm	40"	1,015mm	51"	1,300mm	35"	900mm
HSI 800	58"	1,480mm	61"	1,550mm	79"	2,000mm	61"	1,550mm
HSI 810	58"	1,480mm	61"	1,550mm	79"	2,000mm	70"	1,750mm
HSI 1010	73"	1,860mm	77"	1,950mm	97"	2,450mm	85"	2,170mm
HSI 1020	73"	1,860mm	77"	1,950mm	97"	2,450mm	93"	2,370mm
HSI 1300	95"	2,415mm	102"	2,600mm	124"	3,150mm	93"	2,370mm

TYPICAL PHYSICAL PROPERTIES												
MODEL	ROTOR SIZE (D X W)		MAX FEED		FEED OPENING		CAPACITY		MOTOR POWER		WEIGHT	
	mm x mm	inch x inch	mm	inch	mm x mm	inch x inch	mtph	stph	kW	hp	kg	lbs
HSI 500	500x500	20" x 20"	200	8"	380 x 500	15" x 20"	50 -75	55 -85	37,2	50	1,200	2,645
HSI 800	800x800	31" x 31"	300	12"	620 x 800	24" x 31"	75 -100	85 -115	74,5	100	5,800	12,787
HSI 810	800x1,000	31" x 40"	320	13"	620 x 1,000	24" x 40"	100 -130	115 -145	93,2	125	6,800	14,991
HSI 1010	1,000x1,000	40" x 40"	480	19"	800 x 1,000	31" x 40"	150 -220	170 -245	149,1	200	13,500	29,762
HSI 1020	1,000x1,200	40" x 47"	580	23"	800 x 1,200	32" x 47"	250 -300	280 -335	186,4	250	14,300	31,526
HSI 1300	1,300x1,200	51" x 47"	700	27.5"	1,000 x 1,200	40" x 47"	320 -400	360 -445	223,7	300	16,450	36,266